

# Anillo Chasqueado, Externo, Métrico

Para Rodamientos.

Una vez instalado en la ranura de un eje, la parte del anillo que sobresale de la ranura tiene un conjunto en su lugar.

# CBS Sección Constante

## DIN 5417



Diámetro libre y dimensiones del anillo con sección B-B

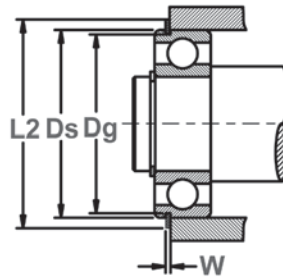
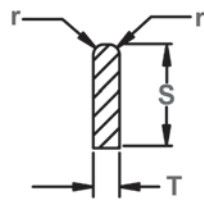
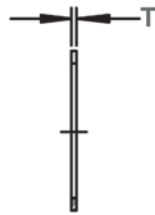

Diámetro del eje y dimensiones de la ranura

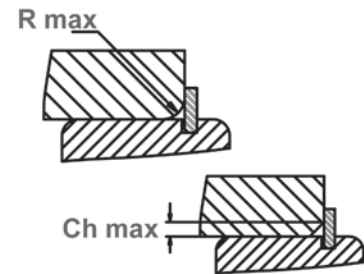

Radio de esquina y bisel máximos

NÚMERO DEL ANILLO	DIÁMETRO DEL EJE		DIMENSIONES DE LA RANURA				DIMENSIONES Y PESO DEL ANILLO										DATOS SUPLEMENTARIOS				
							ESPAZOR		SECCIÓN		DIÁMETRO LIBRE		SEPARACIÓN	RADIO		PESO	L2	Pg	Pr	R max	Pr
	Ds DEC	Ds mm	Dg	TOL.	W	TOL.	T	TOL.	S	TOL.	Df	TOL.		g	r min.						
CBS-30	1.1811	30	28.17		1.35		1.12		3.25		27.4		3	0.4	2.8	34.7	13.7	16.6	2.0	2.91	16.0
CBS-32	1.2598	32	30.15		1.35		1.12		3.25		29.4		3	0.4	3.0	36.7	14.6	14.6	2.0	2.57	13.0
CBS-35	1.3780	35	33.17		1.35		1.12		3.25		32.4	+0,4	3	0.4	3.2	39.7	16.0	13.4	2.0	2.42	11.0
CBS-37	1.4567	37	34.77		1.35		1.12		3.25		34.0		3	0.4	3.4	41.3	20.7	13.6	2.0	2.45	10.0
CBS-40	1.5748	40	38.10		1.35		1.12		3.25		37.3		3	0.4	3.6	44.6	19.3	13.5	2.0	2.50	8.0
CBS-42	1.6535	42	39.75	-0,25	1.35		1.12		3.25		38.9		3	0.4	3.8	46.3	23.5	12.9	2.0	2.39	7.0
CBS-44	1.7323	44	41.75		1.35		1.12		3.25		40.9		3	0.4	4.0	48.3	24.6	12.4	2.0	2.29	7.0
CBS-47	1.8504	47	44.60		1.35		1.12		4.04		43.7	+0,5	4	0.4	5.3	52.7	28.8	12.1	2.0	2.29	7.0
CBS-50	1.9685	50	47.60		1.35		1.12		4.04		46.7		4	0.4	5.8	55.7	30.6	13.3	2.0	2.60	6.0
CBS-52	2.0472	52	49.73		1.35		1.12		4.04		48.8		4	0.4	5.9	57.9	31.6	12.8	2.5	2.01	6.0
CBS-55	2.1654	55	52.60		1.35		1.12		4.04		51.7		4	0.4	6.2	60.7	33.8	11.8	2.5	1.90	5.0
CBS-56	2.2047	56	53.60		1.35		1.12		4.04		52.4		4	0.4	6.5	61.7	34.5	12.1	2.5	1.95	5.0
CBS-58	2.2835	58	55.60		1.35		1.12		4.04		54.4		4	0.4	6.7	63.7	35.6	11.5	2.5	1.89	5.0
CBS-62	2.4409	62	59.61		1.90		1.70		4.04		58.2		4	0.6	10.5	67.7	38.1	37.6	2.5	6.18	5.0
CBS-65	2.5591	65	62.60		1.90		1.70		4.04		61.2		4	0.6	11.0	70.7	40.0	34.9	2.5	5.89	4.0
CBS-68	2.6772	68	64.82		1.90		1.70		4.85		63.4		5	0.6	12.6	74.6	55.5	40.9	2.5	7.06	4.0
CBS-72	2.8346	72	68.81		1.90		1.70		4.85		67.4	+0,8	5	0.6	14.7	78.6	59.0	38.9	2.5	6.71	4.0
CBS-75	2.9528	75	71.83		1.90	+0,3	1.70		4.85		70.4		5	0.6	15.3	81.6	61.5	36.6	2.5	6.46	3.0
CBS-80	3.1496	80	76.81		1.90		1.70		4.85		75.4		5	0.6	16.3	86.6	65.7	34.8	3.0	5.25	3.0
CBS-85	3.3465	85	81.81		1.90		1.70		4.85		80.4		5	0.6	17.5	91.6	70.0	33.5	3.0	5.16	3.0
CBS-90	3.5433	90	86.79		2.70		2.46	-0,1	4.85	-0,15	85.4		5	0.7	26.6	96.5	74.0	93.9	3.0	14.80	2.0
CBS-95	3.7402	95	91.82		2.70		2.46		4.85		90.4		5	0.7	28.2	101.6	76.3	86.8	3.5	12.00	2.0
CBS-100	3.9370	100	96.80		2.70		2.46		4.85		95.2		5	0.7	29.2	106.5	82.5	80.8	3.5	11.40	2.0
CBS-110	4.3307	110	106.81		2.70		2.46		4.85		105.2		5	0.7	32.8	116.6	90.7	71.2	3.5	10.40	1.0
CBS-115	4.5276	115	111.81		2.70		2.46		4.85		110.2	+1,0	5	0.7	34.4	121.6	97.7	66.6	3.5	10.00	1.0
CBS-120	4.7244	120	115.21		3.10		2.82		7.21		113.6		7	0.7	60.6	129.7	143.0	140.0	3.5	21.30	2.0
CBS-125	4.9213	125	120.22		3.10		2.82		7.21		118.6		7	0.7	63.0	134.7	155.0	132.0	4.0	17.90	2.0





# CBS Sección Constante

## DIN 5417

### Anillo Chasqueado, Externo, Métrico

Para Rodamientos.

Una vez instalado en la ranura de un eje, la parte del anillo que sobresale de la ranura tiene un conjunto en su lugar.



Diámetro libre y dimensiones del anillo con sección B-B

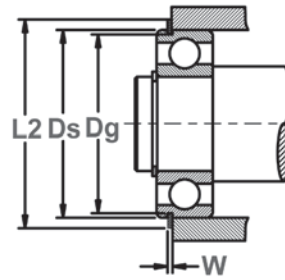
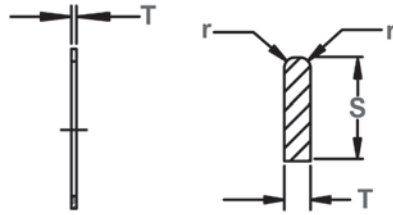

Diámetro del eje y dimensiones de la ranura

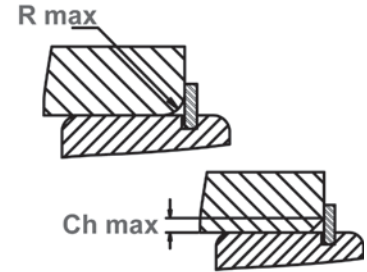

Radio de esquina y bisel máximos

NÚMERO DEL ANILLO	DIÁMETRO DEL EJE		DIMENSIONES DE LA RANURA				DIMENSIONES Y PESO DEL ANILLO							DATOS SUPLEMENTARIOS															
	Ds DEC	Ds mm	DIÁMETRO		ANCHURA		ESPESOR		SECCIÓN		DIÁMETRO LIBRE		SEPARACIÓN g	RADIO r min.	PESO kg/1000	L2	Pg	Pr	R max Ch max	Pr kN	R.P.M. X1000 (1/min)								
			Dg	TOL.	W	TOL.	T	TOL.	S	TOL.	Df	TOL.																	
																						q	r min.	kg/1000	L2	Pg	Pr	R max	Pr
CBS-130	5.1181	130	125.22		3.10		2.82		7.21		123.6	+1.0	7	0.7	65.6	139.7	166.0	124.7	4.0	17.30	1.0								
CBS-140	5.5118	140	135.23		3.10		2.82		7.21		133.0		7	0.7	70.6	149.7	180.0	111.6	4.0	16.00	1.0								
CBS-145	5.7087	145	140.23		3.10		2.82		7.21		138.0		7	0.7	73.0	154.7	186.0	106.4	4.0	15.50	1.0								
CBS-150	5.9055	150	145.24		3.11		2.83		7.21		142.9	+1.6	7	0.7	77.2	159.7	193.0	101.5	4.0	15.00	1.0								
CBS-160	6.2992	160	155.22		3.12	+0.3	2.84		7.21		152.9		7	0.7	81.0	169.7	206.0	92.0	4.0	14.10	1.0								
CBS-170	6.6929	170	163.65		3.13		2.85		9.60		161.3		10	0.7	122.0	182.9	283.0	148.0	5.0	18.70	1.0								
CBS-180	7.0866	180	173.66		3.14		2.86		9.60	-0.15	171.2		10	0.7	128.0	192.9	292.0	135.0	5.0	17.70	1.0								
CBS-190	7.4803	190	183.64		3.15		2.87		9.60		181.0		10	0.7	139.0	202.9	311.0	124.0	5.0	16.70	1.0								
CBS-200	7.8740	200	193.65		3.16		2.88	-0.1	9.60		191.0		10	0.7	148.0	212.9	336.0	116.0	5.0	16.00	1.0								
CBS-210	8.2677	210	203.60		3.17		2.89		9.60		200.9		10	1.2	156.0	222.8	356.0	106.0	6.0	12.70	1.0								
CBS-215	8.4646	215	208.60		3.18		2.90		9.60		205.9	+1.8	10	1.2	160.0	227.8	376.0	103.0	6.0	12.40	1.0								
CBS-225	8.8583	225	217.00	-0.50	3.19		2.91		10.00		214.3		10	1.2	196.0	237.0	462.0	144.0	6.0	17.90	1.0								
CBS-230	9.0551	230	222.00		3.20		2.92		10.00		219.2		10	1.2	200.0	242.0	473.0	139.1	6.0	17.50	1.0								
CBS-240	9.4488	240	232.00		3.21		2.93		10.00		229.2		10	1.2	209.0	252.0	495.0	130.0	6.0	16.80	0.5								
CBS-250	9.8425	250	242.00		3.22	+0.4	2.94		10.00		239.2		10	1.2	220.0	262.0	514.0	122.0	6.0	16.10	0.5								
CBS-260	10.2362	260	252.00		3.23		2.95		10.00		247.5		10	1.2	230.0	272.0	536.0	114.0	6.0	15.50	0.5								
CBS-270	10.6299	270	262.00		3.24		2.96		10.00		257.5		10	1.2	240.0	282.0	556.0	107.0	6.0	14.90	0.5								
CBS-280	11.0236	280	272.00		3.25		2.97		10.00		267.5	+2.5	10	1.2	250.0	292.0	578.0	101.0	6.0	14.40	0.5								
CBS-290	11.4173	290	282.00		3.26		2.98		10.00		277.5		10	1.2	260.0	302.0	598.0	95.4	6.0	13.90	0.4								
CBS-300	11.8110	300	290.00		3.27		2.99		12.00		284.5		10	1.5	400.0	314.0	694.0	230.0	7.0	34.20	0.6								
CBS-310	12.2047	310	300.00		3.28		2.100		12.00	-0.30	294.0		10	1.5	412.0	324.0	800.0	218.0	7.0	28.40	0.5								
CBS-320	12.5984	320	310.00		3.29		2.101		12.00		304.0		10	1.5	420.0	334.0	824.0	207.0	7.0	27.60	0.5								
CBS-340	13.3858	340	330.00		3.30	+0.5	2.102	-0.2	12.00		324.0		10	1.5	446.0	354.0	875.0	187.0	7.0	26.00	0.4								
CBS-360	14.1732	360	350.00		3.31		2.103		12.00		343.0	+3.0	10	1.5	475.0	374.0	930.0	169.0	7.0	24.50	0.4								
CBS-370	14.5669	370	360.00		3.32		2.104		12.00		353.0		10	1.5	485.0	384.0	955.0	162.0	7.0	23.80	0.4								
CBS-380	14.9606	380	370.00		3.33		2.105		12.00		363.0		10	1.5	500.0	394.0	995.0	154.0	7.0	23.20	0.4								
CBS-400	15.7480	400	390.00		3.34		2.106		12.00		383.0		10	1.5	525.0	414.0	1040.0	144.0	7.0	22.10	0.3								